

The "Classic Line by Screen Research", is an affordable range of for high quality video projection screens for Home Theater installations. Manufactured in Europe, easy to configure and fast to install, the products offers advanced design features unmatched before in this price category, as the highly recognized and ISF certified SolidPix™ screen surfaces for superior image fidelity.

On-Wall Motorized Screen

The specificity of this product is the attention brought to the design in order to get a perfect result, an ideal flat surface and a quiet mechanism. Automatic adjustable tab-tensioning system, highly precise black borders applied with high frequency welding, vibration proof and silent stop motors, crease proof, fold-free rolling mechanism, are just examples of the attention to detail and quality that is characteristic of this product.

Depending on your aesthetic preferences, you can choose between of 2 different systems of lateral tensioning of the screen surface: Classic or Constant Tensioning System, that are both very efficient and do not require any adjustment.

All the visible and invisible features of this product will guaranty an enjoyable and durable home theater experience.



ON-Wall Motorized Classic version



ON-Wall Motorized CTS version

Screen Surface:

- > SolidPix™ High Definition screen surface
- > Matte White or Dark Grey for ambient light compatibility
- > Imaging Science Foundation (ISF) certification
- > Micro-perforated version for acoustically transparent applications (PerfPix)

Features:

- > Casing available in White or Black
- > Classic or Constant Tensioning system available
- > Crease proof, fold free technology
- > Vibration proof and silent stop motors

Standard accessories:

- > Wall-Ceiling mount brackets

Optional accessories:

- > Infrared or Radio Frequency remote control
- > Additional Top Black Drop Length



ON-Wall Motorized Classic version

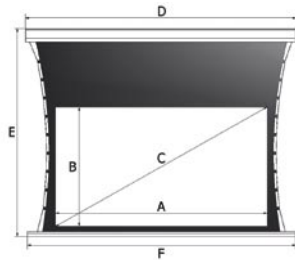

ON-Wall Motorized CTS version

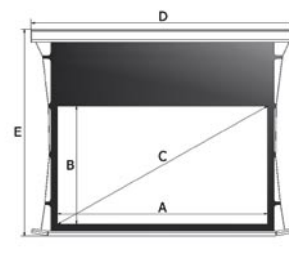

Format	Tensioning system	Model	Code	Net surface width	Net surface height	Net diagonal	Overall width	Overall height	Batten width	Shipment size" (cm)	Gross weight lb (Kg)	Net weight lb (Kg)
				A" (mm)	B" (mm)	C" (mm)	D" (mm)	E" (mm)	F" (mm)			
16:9	Classic	CLCLT-80-178-	PSCHP3100	80 (2032)	44.9 (1142)	91.8 (2331)	96.5 (2452)	61.0 (1551)	95.9 (2436)	104x6x7 (265x15x18)	47.3 (21.5)	40.7 (18.5)
	CTS	CLCTS-80-178-	PSCHP3100									
	Classic	CLCLT-90-178-	PSCHP3101	90 (2286)	50.6 (1284)	103.2 (2622)	106.5 (2706)	66.7 (1693)	105.9 (2690)	114x6x7 (291x15x18)	50.6 (23.0)	44.0 (20.0)
	CTS	CLCTS-90-178-	PSCHP3101									
	Classic	CLCLT-96-178-	PSCHP3102	96 (2438)	53.9 (1370)	110.1 (2797)	112.5 (2859)	70.0 (1779)	111.9 (2843)	120x6x7 (306x15x18)	53.9 (24.5)	47.3 (21.5)
	CTS	CLCTS-96-178-	PSCHP3102									
	Classic	CLCLT-100-178-	PSCHP3103	100 (2540)	56.2 (1427)	114.7 (2913)	116.5 (2960)	72.3 (1836)	115.9 (2944)	124x6x7 (316x15x18)	57.2 (26.0)	50.6 (23.0)
	CTS	CLCTS-100-178-	PSCHP3103									
2.40	Classic	CLCLT-110-178-	PSCHP3104	110 (2794)	61.8 (1570)	126.2 (3205)	126.5 (3214)	77.9 (1979)	125.9 (3198)	134x6x7 (341x15x18)	60.5 (27.5)	53.9 (24.5)
	CTS	CLCTS-110-178-	PSCHP3104									
	Classic	CLCLT-120-178-	PSCHP3105	120 (3048)	67.4 (1712)	137.6 (3496)	136.5 (3468)	83.5 (2121)	135.9 (3452)	144x6x7 (367x15x18)	63.8 (29.0)	57.2 (26.0)
	CTS	CLCTS-120-178-	PSCHP3105									
	Classic	CLCLT-80-240-	PSCHP3100	80 (2032)	33.3 (847)	86.7 (2201)	96.5 (2452)	49.4 (1256)	95.9 (2436)	104x6x7 (265x15x18)	42.9 (19.5)	36.3 (16.5)
	CTS	CLCTS-80-240-	PSCHP3100									
	Classic	CLCLT-90-240-	PSCHP3101	90 (2286)	37.5 (953)	97.5 (2477)	106.5 (2706)	53.6 (1361)	105.9 (2690)	114x6x7 (291x15x18)	46.2 (21.0)	39.6 (18.0)
	CTS	CLCTS-90-240-	PSCHP3101									
2.40	Classic	CLCLT-96-240-	PSCHP3102	96 (2438)	40.0 (1016)	104.0 (2642)	112.5 (2859)	56.1 (1425)	111.9 (2843)	120x6x7 (306x15x18)	49.5 (22.5)	42.9 (19.5)
	CTS	CLCTS-96-240-	PSCHP3102									
	Classic	CLCLT-100-240-	PSCHP3103	100 (2540)	41.7 (1058)	108.3 (2752)	116.5 (2960)	57.8 (1467)	115.9 (2944)	124x6x7 (316x15x18)	52.8 (24.0)	46.2 (21.0)
	CTS	CLCTS-100-240-	PSCHP3103									
	Classic	CLCLT-110-240-	PSCHP3104	110 (2794)	45.8 (1164)	119.2 (3027)	126.5 (3214)	61.9 (1573)	125.9 (3198)	134x6x7 (341x15x18)	56.1 (25.5)	49.5 (22.5)
	CTS	CLCTS-110-240-	PSCHP3104									
	Classic	CLCLT-120-240-	PSCHP3105	120 (3050)	50.0 (1270)	130.0 (3302)	136.5 (3468)	66.1 (1679)	135.9 (3452)	144x6x7 (367x15x18)	59.4 (27.0)	52.8 (24.0)
	CTS	CLCTS-120-240-	PSCHP3105									

Intermediate sizes available on request

Screen fabric table

Fabric category	Description	Gain	Min/Max	Acoustically transparent	ISF Video
SolidPix	SolidPix2 Matte White 1.0	1.0	70"/120"		•
	SolidPix2 High-contrast Gray 0.9	0.9	70"/120"		•
PerfPix	PerfPix Matte White 1.0	1.0	70"/120"	•	•
	PerfPix High-contrast Gray 0.9	0.9	70"/120"	•	•



Installation systems

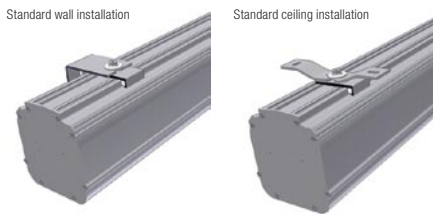

Casing dimension

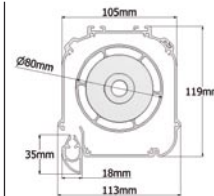

Brackets dimension

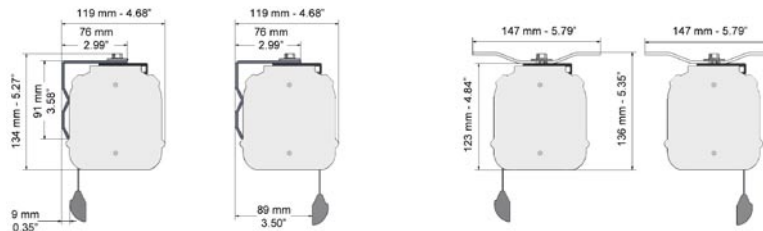

Tolerance on screen dimensions: ± 10 mm (± 0.4").
All quoted weights are approximate (± 5%). Weights of finished screens will vary depending on options specified.